



4FT/5FT/6FT LANDSCAPE RAKE

OWNER'S MANUAL



WARNING:

Read carefully and understand all **INSTRUCTIONS** before operating. Failure to follow the safety rules and other basic safety precautions may result in serious personal injury.

Item #180267, 180268, 180269

Thank you very much for choosing a NORTHERN TOOL + EQUIPMENT CO., INC. Product! For future reference, please complete the owner's record below:

Model: _____ Purchase Date: _____

Save the receipt, warranty and these instructions. It is important that you read the entire manual to become familiar with this product before you begin using it.

This machine is designed for certain applications only. Northern Tool + Equipment cannot be responsible for issues arising from modification. We strongly recommend this machine is not modified and/or used for any application other than that for which it was designed. If you have any questions relative to a particular application, DO NOT use the machine until you have first contacted Northern Tool + Equipment to determine if it can or should be performed on the product.

For technical questions please call **1-800-222-5381**.

GENERAL SAFETY RULES



WARNING: The warnings, cautions, and instructions discussed in this instruction manual cannot cover all possible conditions or situations that could occur. It must be understood by the operator that common sense and caution are factors which cannot be built into this product, but must be supplied by the operator.

SAVE THESE INSTRUCTIONS



CAUTION: THE FOLLOWING SAFETY PRECAUTIONS SHOULD BE THOROUGHLY UNDERSTOOD BEFORE ATTEMPTING TO BEGIN ASSEMBLING THIS MACHINE.

- **Select an area for assembly that is clean and free of any debris** which might cause anyone working in the area to trip and fall.
- **Do not lift heavy parts or assemblies.** Use a crane jack, block and tackle, forklift or other mechanical device.
- **Never put hands or any other body part under blocked-up assemblies if at all possible.**
- **After completing assembly, thoroughly inspect the machine** to be sure that all nuts, bolts, hydraulics, fittings or any other fastened assemblies have been thoroughly tightened.
- **Stay alert,** watch what you are doing and use common sense when operating this machine. Do not operate while you are tired or under the influence of drugs, alcohol or medication. A moment of inattention while operating may result in serious personal injury.
- **Use safety apparel and equipment.** Use safety goggles or safety glasses with side shields which comply with current national standards, or when needed, a face shield. Use as dust mask in dusty work conditions. Also use non-skid safety shoes, hardhat, gloves, dust collection systems, and hearing protection when appropriate.
- **Keep alert** and watch the front as well as the rear when working with the implement.
- **Do not operate close to ditches or creeks.** Slow down when operating over rough ground.

- **Always be sure the implement is in the fully raised position when in transport.**
- **When removing, changing the angle or reversing the rake,** be sure that your feet are never under the rake.
- **Use extreme caution** when backfilling deep holes and trenches.
- **Be careful to avoid catching the rake on stumps or other immovable objects.**
- **Use care when working on slopes.**
- **Avoid excessive speed during operation.**
- **Make adjustments only** when the implement is attached to the tractor.
- **When using the rake in a reverse position, use extra care.** Do not ram rake into piles of dirt. Tractor lift arms and the rake are not built to take high-impact loads in this position. Ramming backwards can also dislodge operator from seat and/or tractor controls, resulting in possible serious injury or death.
- **Spring steel rake tines in operation may suddenly fling rocks and clods of earth.** Keep all bystanders 25 feet or more away from an operating landscape rake.
- **Before operating equipment** — If you have any questions regarding the proper assembly or operations, contact your dealer or the manufacturer.

ASSEMBLY

1. The two main subassemblies of the landscape rake are heavy and awkward to handle. It is recommended that you have one or two helpers to complete the assembly.
2. It is suggested that you mount the main frame on a 3-pt. hitch of your tractor before assembling the landscape rake.
3. Install the rake tine bar assembly to the mounting frame and retain with locking pin.

DIAGRAM & PARTS LIST

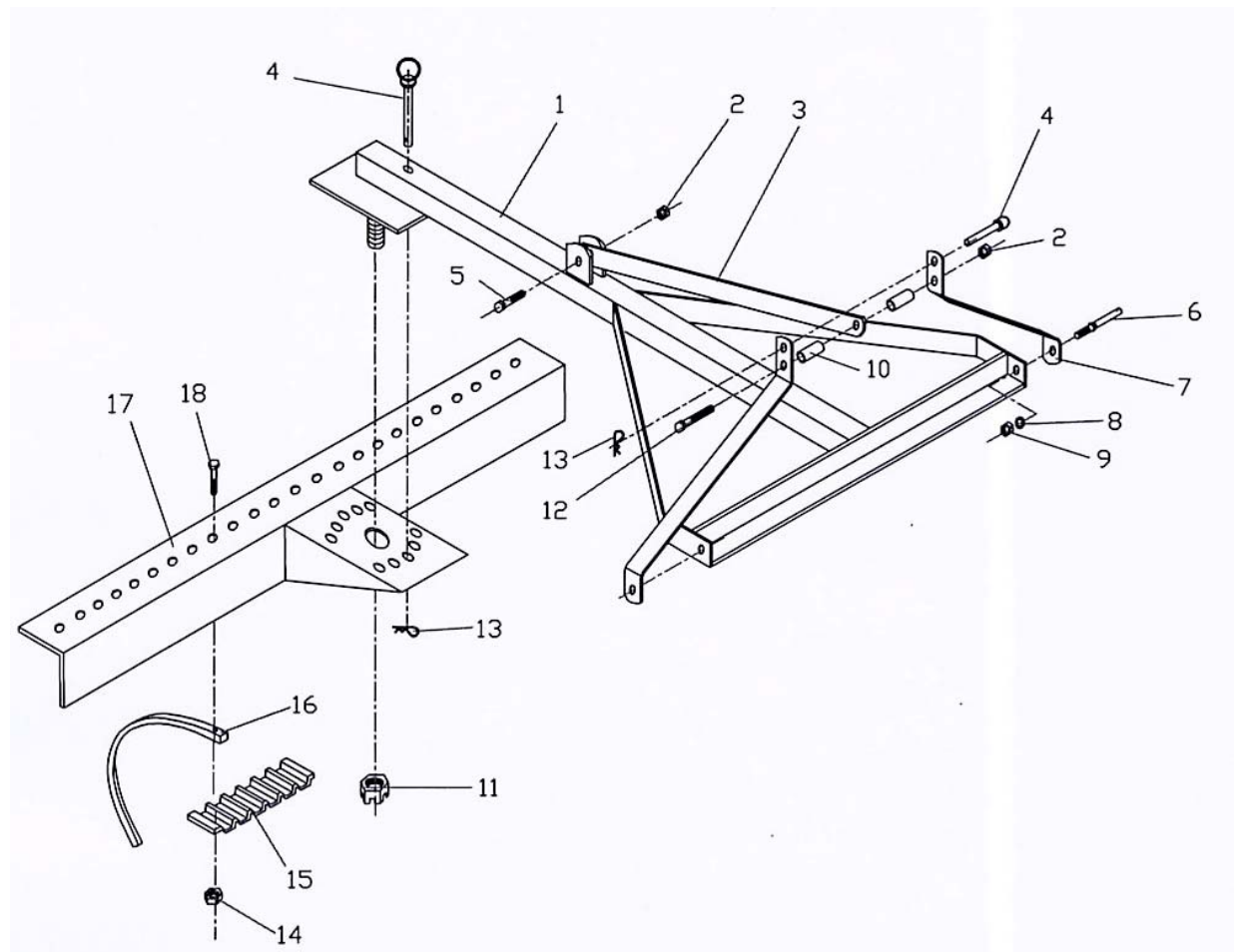

Part No.	Description	Qty.	Part No.	Description	Qty.
1	Main Frame Weldment	1	10	Steel Collar	2
2	Lock Nut M16	2	11	Slotted Nut M30	1
3	Brace	1	12	Bolt M16x100	1
4	Pin	2	13	Hair Pin	2
5	Bolt M16x50	1	14	Nut M10	4': 24, 5':30, 6': 36
6	Draw Pin	2	15	Tooth Support	4': 4, 5':5, 6':6
7	Side Bar	2	16	Tooth	4': 24, 5':30, 6': 36
8	Lock Washer 22	2	17	Tinebar Weldment	1
9	Nut M22x1.5	2	18	Bolt M10x30	4': 24, 5':30, 6': 36

For replacement parts and technical questions, please call **1-800-222-5381**.

WARNING

Some dust created by power sanding, sawing, grinding, drilling, and other construction activities contains chemicals known to the State of California to cause cancer, birth defects or other reproductive harm.

Some examples of these chemicals are:

- crystalline silica from bricks and cement and other masonry products, and
- arsenic and chromium from chemically-treated lumber.

Your risk from these exposures varies, depending on how often you do this type of work. To reduce your exposure to these chemicals: work in a well ventilated area, and work with approved safety equipment, such as those dust masks that are specially designed to filter out microscopic particles.



Northern Tool + Equipment Co.,
2800 Southcross Drive West
P.O. Box 1499 Burnsville, MN 55337-0499
Made in China.