

EarthWay[®] Garden

ASSEMBLY and OPERATING INSTRUCTIONS
for *EarthWay*
MODEL 6500
High Wheel Cultivators

HELPFUL HINTS: READ DIRECTIONS BEFORE ASSEMBLY AND ENSURE ALL PARTS ARE ACCOUNTED FOR. IF STILL HAVING TROUBLE ASSEMBLING YOU CAN CALL 574-848-7491 OR 800-294-0671 FOR ASSISTANCE.

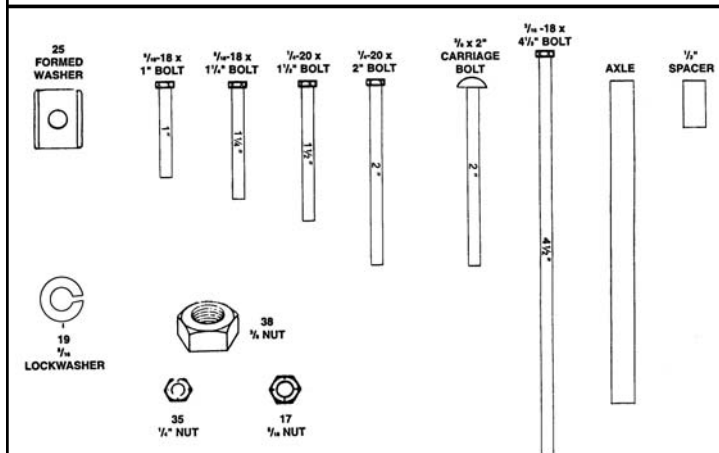

Your High Wheel Cultivator is intended for use in soil already plowed or tilled. It is not designed as a ground breaking tool.

1. Remove and identify all loose parts from carton.
2. Put handle grips (9) on round end of upper handles (4)
3. Insert Axle bolt (18) through hole in flat end of one of the lower handles (5). Next insert the bolt through the hole in the straight end of frame (8). Place axle (26) into center of wheel (1). Now put axle bolt through the axle, then put other frame (8) and flat end of other lower handle over axle bolt and fasten with lock washer (19) and hex nut (17).
4. Insert bolt (37) through hole in bottom of right tool support (6). Now put spacer (10) and left tool support (7) over bolt and fasten with hex nut (17).
5. Put tool support assembly from Step 4 between frame ends (8) with spacer end down and curve toward wheel. Now fasten frame to tool support assembly with bolt (15) and hex nut (35).
6. Now take upper handles (4) and attach to lower handles (5) using bolt (30) and hex nut (17). Note: You may want to adjust the height of the handle before using for easier operating. To adjust height, simply move bolt (30) to higher or lower position on tool supports (6) and (7).
7. Now install the cross brace (2) to upper handles (4). Take bolt (14) and put bolt through hole in cross brace then through upper handle (4). Fasten with hex nut (35). Repeat on other side.

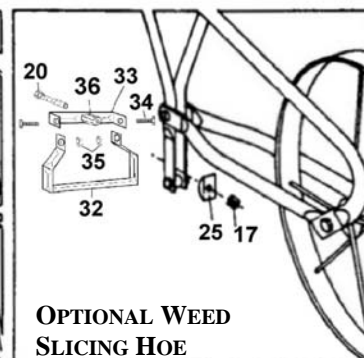
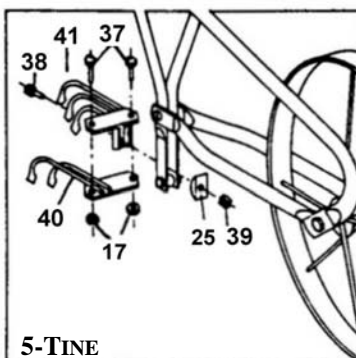
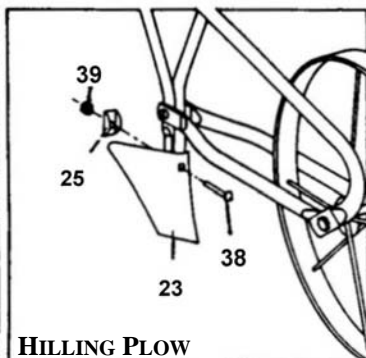
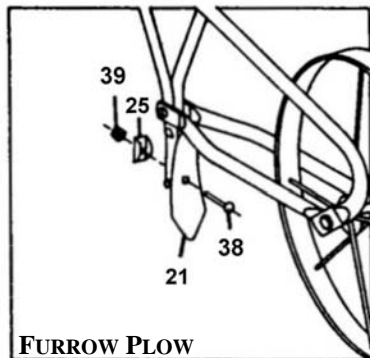

ASSEMBLY OF TOOLS (see above)

FURROW PLOW

Place Furrow Plow (21) in front of tool support slot. Put carriage bolt (38) through square hole and through slot in tool support. Next put formed washer (25) over carriage bolt (38) and tool support then fasten with lock nut (39).

HILLING PLOW

Place Hilling Plow in position shown above. Follow instructions from above.

FIVE TINE

Assemble 5-Tine as pictured above and fasten with two (37) and two (17) hex nuts. Next put carriage bolt (38) through rear of the assembly and through tool support, fasten with formed washer (25) and lock nut (39).

PLEASE CALL IF YOU ARE MISSING ANY PARTS, HAVE DIFFICULTY IN ASSEMBLY, OR HAVE ANY QUESTIONS REGARDING THE SAFE OPERATION OF THIS PRODUCT.

SUPPORT HOT LINE: 574-848-7491 OR 800-294-0671

EMAIL: SUPPORT@EARTHWAY.COM

EarthWay®

Products, Inc.

P.O. Box 547
Bristol, Indiana 46507
(574) 848-7491
www.earthway.com

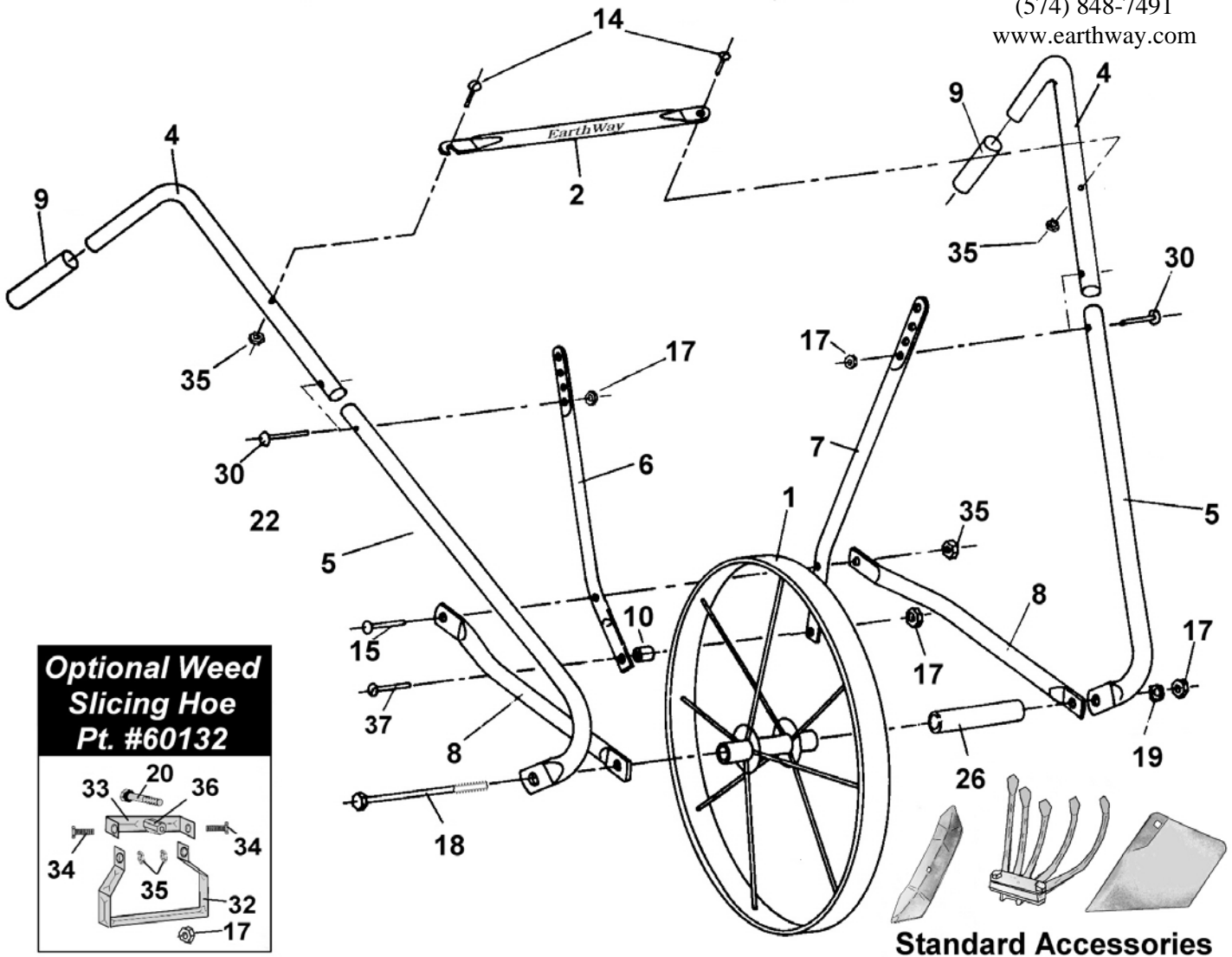

Optional Weed Slicing Hoe Pt. #60132

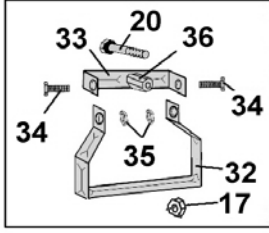

Standard Accessories

6500 High Wheel Cultivator

Key #	Part #	Description	Key #	Part #	Description	Key #	Part #	Description
1	60130	Wheel	17	32102	* 5/16-18 Hex Nut	32	44244	Optional Slicing Hoe Blade
2	23604	Cross Brace	18	31116	* 5/16-18 X 4 1/2" Hex Bolt	33	44252	Optional Slicing Hoe Bracket
4	23401	Upper Handle	19	34104	* 5/16 Split Lock Washer	34	31101	Optional 1/4-20 X 3/4" Hex Bolt
5	23204	Lower Handle	20	31125	* 5/16-18 X 2" Hex Bolt	35	32103	Optional 1/4-20 Nylon Locknut
6	23601	Right Tool Support	21	44227	Furrow Plow	36	44253	Optional Tool Adapter
7	23602	Left Tool Support	22	60141	5-Tine Assembly, Includes Key 40 & 41	37	31111	* 5/16-18 X 1" Hex Bolt
8	23104	Frame	23	44228	Hilling Plow (Mold Board Plow)	38	37105	* 3/8-16 X 2" Carriage Bolt
9	19111	Handle Grip	24	60132	Optional Slicing Hoe Assembly	39	32109	* 3/8-16 Hex Nut
10	23605	Tool Support Spacer	25	43033	Formed Washer	40	60138	Two Tine Assembly
14	31100	* 1/4-20 X 1 1/2" Hex Bolt	26	23500	Axle	41	60139	Three Tine Assembly
15	31120	* 1/4-20 X 2" Hex Bolt	30	31115	* 5/16-18 X 1 1/2" Hex Bolt			

WARRANTY

EARTHWAY guarantees this product to be free of defects in original workmanship and materials for a period of 90-days from sale to the original user. If any defect develops during this period EARTHWAY will repair or replace this product at no charge provided the defect is not the result of mishandling or tampering and that this product is received at the factory with shipping charges prepaid. For quicker service you may call EARTHWAY at 574-848-7491 or write and describe the nature of the defect and we will send repair parts to you. EARTHWAY PRODUCTS, INC. makes no warranty or guarantee against corrosion failure on models with plated steel or painted steel frames. Clean your cultivator well after each use and dry thoroughly. Warranty covers parts only, but not labor charges to install those parts.