



# Generator Wheel Kit

ITEM # 165919

For use on 10000, 13000, and 15000 PPG, IPG or DPG model North Star Generators

M165919F

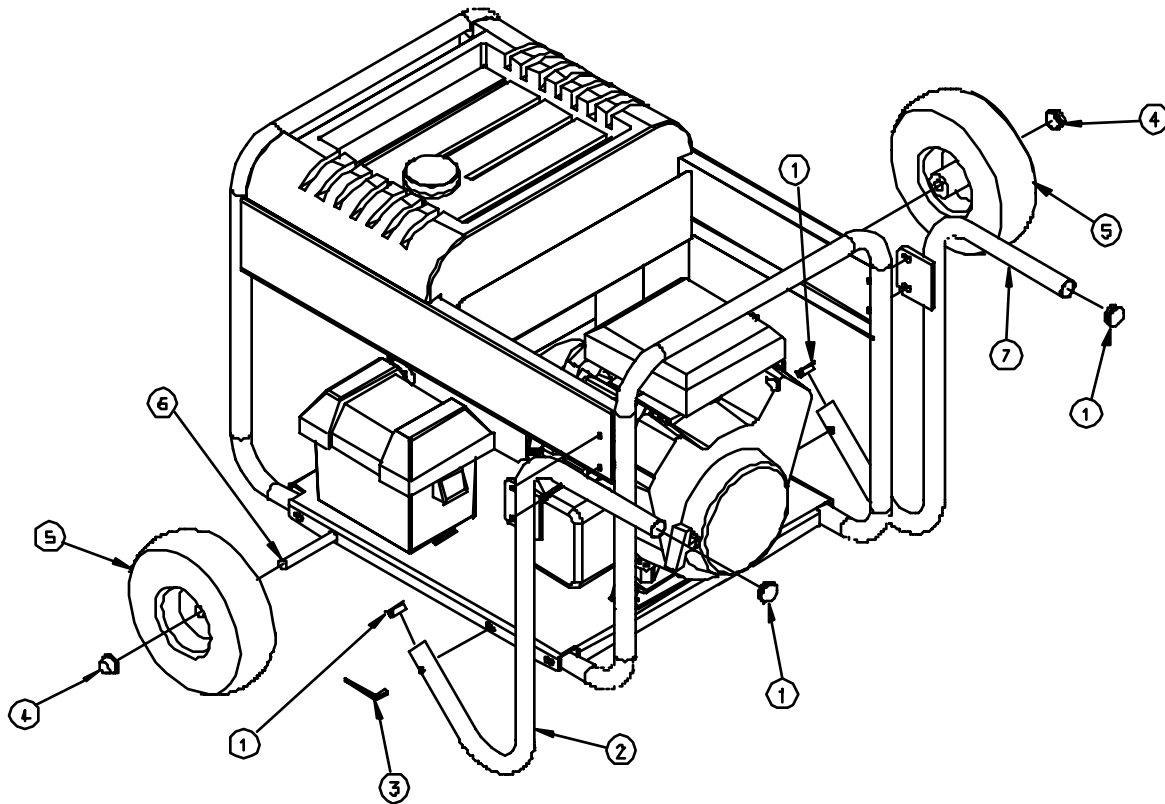

## OWNER'S MANUAL

Exploded View

00180

<b>COMPONENT LIST</b>			
<b>Ref.</b>	<b>Item #</b>	<b>Description</b>	<b>Qty.</b>
1	30748	Handle End Cap	4
2	777134	Left Handle Weldment	1
3	30749	3/16" Allen Wrench	1
4	157163	Hub Cap	2
5	2278	10" Pneumatic Wheel	2
6	305618	Solid Steel Axle	1
7	777133	Right Handle Weldment	1

# STEP 1

- Open hardware bag and separate the components.

## FASTENERS (actual size)



5/16-18 X 1.00"  
Hex head bolt Qty. 4

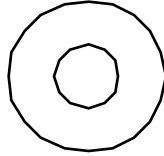

5/16" Flat washer  
Qty. 4

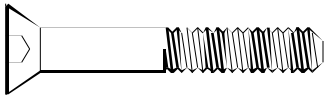

5/16-18 X 1.50"  
Flat head bolt Qty. 2

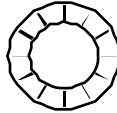

5/16" Star washer  
Qty. 2

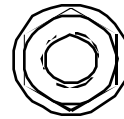

5/16" Flange nut  
Qty. 6

## MISCELLANEOUS COMPONENTS (not actual size)



Hub Cap  
Qty. 2



Handle End Cap  
Qty. 4



3/16" Allen Wrench  
Qty. 1

## STEP 2

- Secure generator on blocks at least 7" tall. Make sure the space between the holes for the axle is not obstructed.

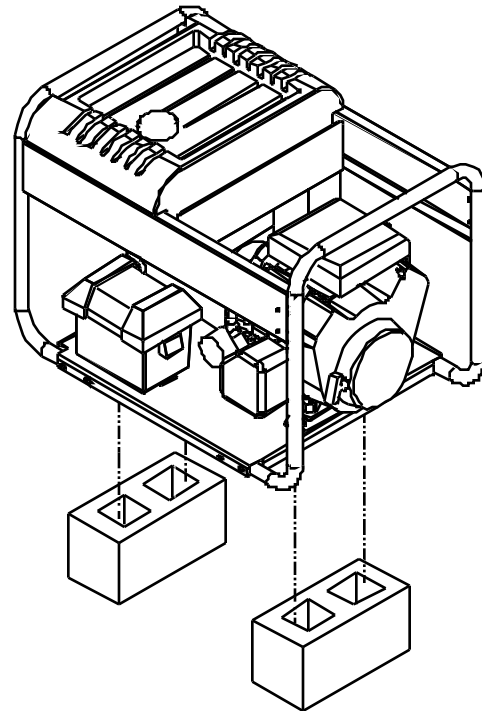

00179

## STEP 3

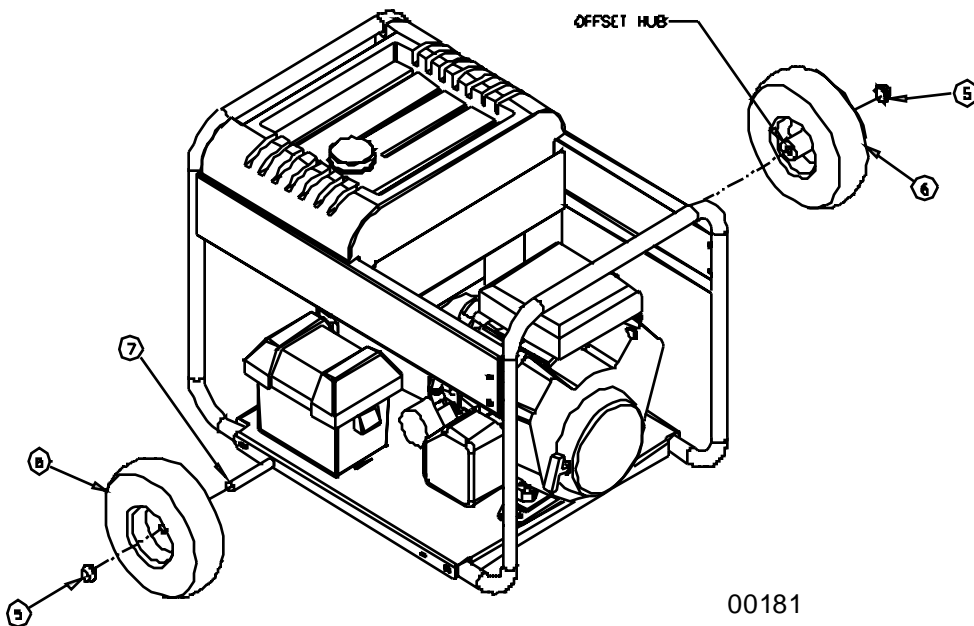

00181

- Tap one hub cap (5) onto the axle using a hammer.
- Slide one wheel (6) onto the axle (7), so that the offset hub is opposite the hub cap (5).
- Slide the axle (7) through the two holes on the base.
- Slide the second wheel (6) on to the axle (7).
- Grasp the axle (7) to prevent it from sliding as you tap on the second hub cap (5).
- 

Note: Tires may require periodic inflation.

Ref.	Item #	Description	Qty.
5	157163	Hub cap	2
6	2278	10" Pneumatic wheel	2
7	305618	Solid steel axle	1

## STEP 4

- Insert one 5/16-18 X 1.50" (7) with 5/16" star washer (8) through each handle (2) and (4). Tighten the nut (9) finger tight only.
- Insert the four 5/16-18 X 1" bolts (5), with 5/16" flat washer (6) through the handle mount plates. Fasten with 5/16-18 flange nuts (9). Torque to 17 ft-lb.
- With the 3/16" Allen wrench provided (3), tighten the 5/16-18 X 1.50" bolts (7). Do not collapse the tube.
- Snap the handle end caps (1) into the handles (2) and (4).
- Remove the blocks from under the generator.

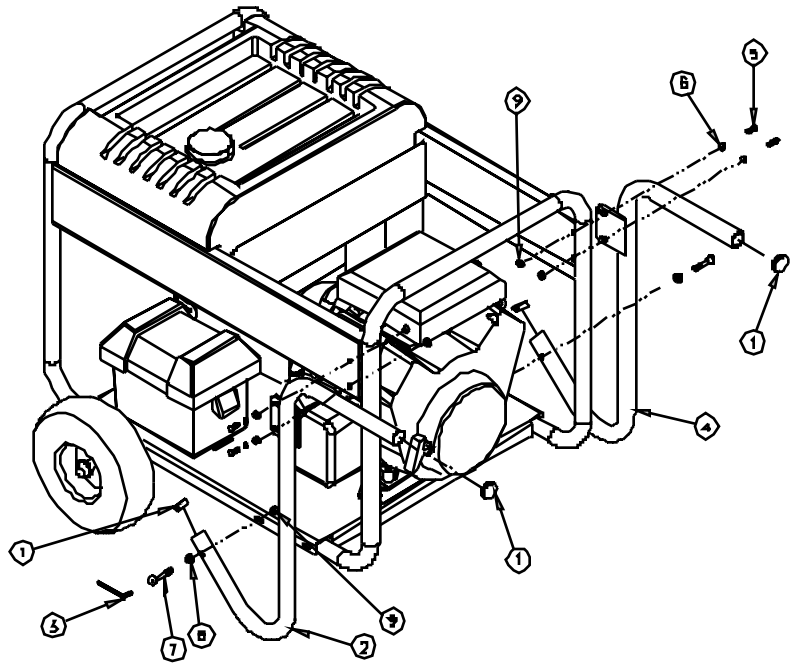

Ref.	Item #	Description	Qty.
1	30748	Handle end cap	4
2	31706	Left handle weldment	1
3	30749	3/16" Allen wrench	1
4	31705	Right handle weldment	1
5		5/16-18 X 1.00" Hex head bolt	4
6		5/16" Flat washer	4
7		5/16-18 x 1.50" Flat head bolt	2
8		5/16" Star washer	2
9		5/16-18 Flange nut	6

00185

**Any Questions, Comments, or Problems  
Call Customer Service 1-800-270-0810**