



### PROCESSES



AC Stick (AC SMAW)  
Welding

**5/3/1**  
**INDUSTRIAL**  
**WARRANTY**

MADE IN **USA**



Lightweight and compact, Hobart's Champion 4500 welder/generator provides you with the power you need wherever and whenever you need it. This unit is an excellent source of generator power, providing up to 4500 surge watts of AC power for emergency backup, as well as hand tools, grinders, lights and battery chargers. As an AC welder, the Champion 4500 delivers up to 140 A of welding power, making it an ideal choice for maintenance and repair projects.

### Comes Complete With:

- 10 ft (3 m) No. 4 electrode cable with holder
- 10 ft (3 m) work cable and clamp

### Applications

- Farm/Home
- Light Maintenance and Repair
- Light Fabrication

### FEATURES

### BENEFITS

|   |  |
|---|--|
| <b>Generator power</b>                          | 4,500 watts surge power and 4,000 watts continuous power   |
| <b>Briggs &amp; Stratton Intek™ 8 HP engine</b> | Fuel-efficient engine with 1-gallon fuel tank  |
| <b>Versatile receptacle package</b>             | Unit features two 20 A 120 VAC and two 20 A 240 VAC receptacles with heavy-duty covers   |
| <b>140 amp AC welder</b>                        | Can handle AC stick electrodes up to 1/8 in diameter   |
| <b>Lightweight and rugged</b>                   | Portable at 190 lb (87 kg) with rollbar frame built for added protection   |
| <b>Hobart's 5/3/1 Industrial Warranty</b>       | Five-year warranty on transformers, stabilizers and generators; three years on electronics (drive motors, rectifiers); and one year on guns (MIG and plasma torches) |

### SPECIFICATIONS (SUBJECT TO CHANGE WITHOUT NOTICE.)

LIGHT INDUSTRIAL



| Rated Output  | Amperage Range | Single-Phase Generator Power               | Dimensions  | Net Weight     |
|---|----------------|--|---|----------------|
| 140 A, 20 V at 30% duty cycle<br>110 A, 25 V at 60% duty cycle<br>90 A, 25 V at 100% duty cycle | 60 – 140 A     | Single-phase, 4 kVA/kW, 120/240 VAC, 60 Hz | H: 20-3/4 in (527 mm)<br>W: 22-3/4 in (577 mm)<br>D: 31-1/4 in (793 mm) | 190 lb (86 kg) |

Certified by Canadian Standards Association to both Canadian and U.S. Standards.

### ENGINE SPECIFICATIONS (SUBJECT TO CHANGE WITHOUT NOTICE.)

| Engine Brand       | Model | Horsepower       | Type                                | Start Ignition | Fuel/Oil Capacity                    |
|--------------------|-------|------------------|-------------------------------------|----------------|--------------------------------------|
| Briggs & Stratton* | Intek | 8 HP at 3600 RPM | 1 cylinder, 4-cycle, OHV air-cooled | Recoil         | Fuel: 1 gal (4 L) Oil: 28 oz (0.8 L) |

\*Engine warranted separately by manufacturer. 2-year consumer use, 90-day commercial use.



**Hobart Welders** An Illinois Tool Works Company

U.S. Distributor Sales Phone 920-735-4576 FAX 800-637-2315  
 Hobart Retail Sales Phone 800-332-3281 FAX 937-332-4161  
 Canadian Sales Phone 888-489-9353 FAX 519-421-0480  
 International Sales Phone 920-735-4509 FAX 920-735-4125

Web Site [www.HobartWelders.com](http://www.HobartWelders.com)



## CONTROL PANEL

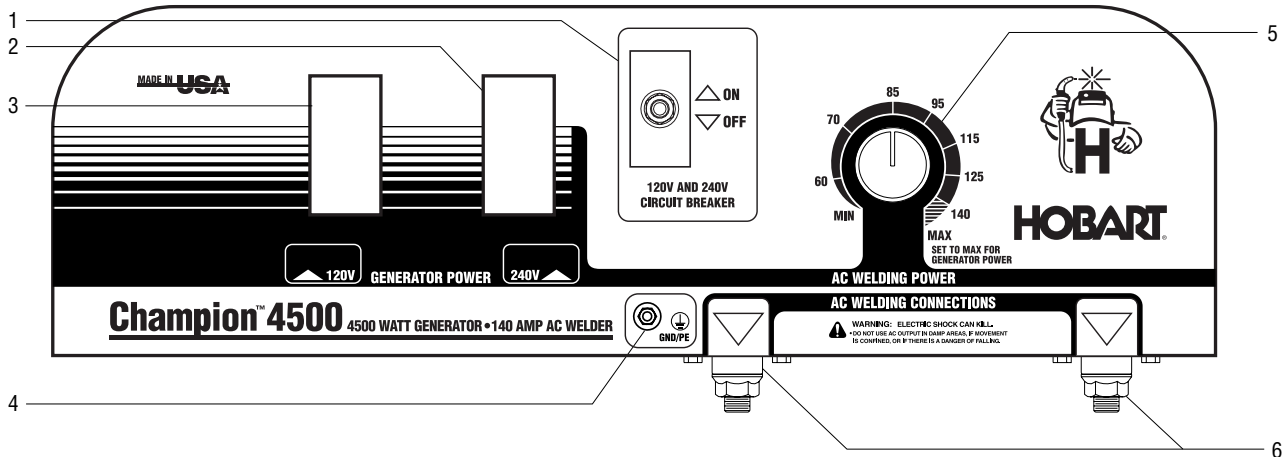

1. Circuit-Breaker Protection
2. 240 VAC Receptacle
3. 120 VAC Receptacle
4. Ground Protection
5. Single Weld Current Control
6. Weld Output Studs

## OPTIONS AND ACCESSORIES



**Protective Cover #195232**  
Water-resistant cover resists stains and mildew, and protects the finish of your welder.



**Portable Running Gear #195187**  
Wheels and extension handle for ease of portability and cable storage.

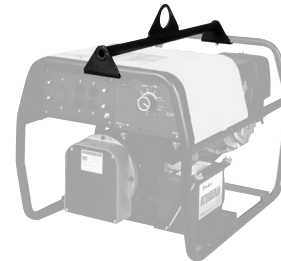

**Lifting Eye #195353**

## ORDERING INFORMATION AND SYSTEM CHECKLIST

| Power Source and Options  | Stock No.      | Description                             | Qty.                       | Price |
|---|----------------|---|----------------------------|-------|
| <b>Champion 4500</b>  | <b>#500491</b> | Recoil start, 120/240 V generator power |                            |       |
| All models come standard with 10 ft (3 m) No. 4 electrode cable with holder, and 10 ft (3 m) work cable with clamp. |                |   |                            |       |
| UPC: #715959301091; Shipping Weight: 200 lb; Carton Dimensions: 32 x 24 x 21; Pallet Qty: 1                         |                |   |                            |       |
| <b>Miscellaneous</b>  |                |   |                            |       |
| Protective Cover  | <b>#195232</b> |   |                            |       |
| Portable Running Gear   | <b>#195187</b> |   |                            |       |
| Lifting Eye   | <b>#195353</b> |   |                            |       |
| <b>Date:</b>  |                |   | <b>Total Quoted Price:</b> |       |

 Certified by Canadian Standards Association to both Canadian and U.S. Standards.

# HOBART

W E L D E R S

**DISTRIBUTED BY:**