



# 1000-LB. HYDRAULIC HOIST

## OWNER'S MANUAL



 **WARNING:** Read carefully and understand all **INSTRUCTIONS** before operating. Failure to follow the safety rules and other basic safety precautions may result in serious personal injury.

Item #141228

Thank you very much for choosing a NORTHERN TOOL + EQUIPMENT CO., INC. Product! For future reference, please complete the owner's record below:

Model: \_\_\_\_\_ Purchase Date: \_\_\_\_\_

Save the receipt, warranty and these instructions. It is important that you read the entire manual to become familiar with this product before you begin using it.

This machine is designed for certain applications only. Northern Tool + Equipment cannot be responsible for issues arising from modification. We strongly recommend this machine is not modified and/or used for any application other than that for which it was designed. If you have any questions relative to a particular application, DO NOT use the machine until you have first contacted Northern Tool + Equipment to determine if it can or should be performed on the product.

For technical questions please call **1-800-222-5381**.

## INTENDED USE

Hydraulic hoist provides the lifting power to lift a 1000-lb. load when fully retracted (500 lbs. when fully extended). Pivots 360° in base for easy loading. Saves time and effort loading and unloading cargo from a pickup bed.

## TECHNICAL SPECIFICATIONS & PACKING LIST

Item	Description
Max lifting capacity	1000 lbs. (retracted)
Min lifting radius	36.6"
Max lifting height	70.8"
Base exterior size	10.6" x 10.6"
Min lifting height	6.7"
Working degree rotation	360°
Max lifting radius	51"

## GENERAL SAFETY RULES



**WARNING:** Read and understand all instructions. Failure to follow all instructions listed below may result in serious injury. **Do not exceed indicated weight capacity.**



**WARNING:** The warnings, cautions, and instructions discussed in this instruction manual cannot cover all possible conditions or situations that could occur. It must be understood by the operator that common sense and caution are factors which cannot be built into this product, but must be supplied by the operator.

## SAVE THESE INSTRUCTIONS

- **Keep work area clean.** Cluttered areas invite injuries.
- **Additional work area conditions.** Do not use hoist in damp or wet locations. Do not expose to rain. Keep work area well lit.
- **Keep children and bystanders away.** Children must never be allowed in the work area. Do not let them operate the hoist or be near a suspended load.

- **Store idle equipment.** When not in use, the hoist must be stored in a dry location to inhibit rust. Always lock the hoist and keep out of reach of children.
- **Use the right tool for the job.** There are certain applications for which this hoist was designed. Never lift or move people. Never exceed stated capacities. Do not modify the hoist and do not use it for a purpose for which it was not intended.
- **Always inspect the chain and hook prior to use.** Do not use if damaged in any way.
- **Dress properly.** Do not wear loose clothing or jewelry as they can be caught in moving parts. Protective clothes and non-skid footwear are recommended when working. Wear restrictive hair covering to contain long hair.
- **Use the proper safety apparel.** Always wear ANSI-approved impact safety glasses, safety shoes, gloves, etc.
- **Do not overreach.** Keep proper footing and balance at all times. Do not reach over or across running machines.
- **Stay alert.** Watch what you are doing, use common sense. Do not operate the hoist when you are tired.
- **Do not operate hoist if under the influence of alcohol or drugs.** Read warning labels on prescriptions to determine if your judgment or reflexes are impaired while taking drugs. If there is any doubt, do not operate the tool.
- **Never lift an object when the vehicle is in motion.**
- **Never stand beneath, in front of, or to the side of the load.**
- **Never use hoist to lift or support people.**
- **Do not leave a suspended load unattended.**
- **Never exceed the 1000-lb. lifting capacity.**
- **Always make sure the vehicle is in park, the engine is off, the parking brake is set and the wheels are blocked before using.**
- **Check all connections periodically and tighten or replace when necessary.**

## MAINTENANCE

- **Maintain your hoist.** It is recommended that the general condition of any tool be examined before it is used. Keep your hoist in good repair by adopting a program of conscientious repair and maintenance in accordance with the recommended procedures found in this manual. If any abnormal vibrations or noise occurs, stop using the hoist immediately and have the problem corrected before further use. Have necessary repairs made by qualified service personnel.
- **Cleaning.** Use only soap and a damp cloth to clean your tools. Many household cleaners are harmful to plastics and other insulation. Never let liquid get inside a tool.
- **Replacement parts and accessories.** When servicing, use only identical replacement parts. Use of any other parts will void the warranty. Only use accessories intended for use with this hoist.
- **Check for damaged parts.** Before using the tool, any part that appears damaged should be carefully checked to determine that it will operate properly and perform its intended function. Any part that is damaged must be replaced.
- **Maintain hoist with care.** Follow instructions for lubricating and changing accessories. The handles must be kept clean and free from oil and grease at all times.

## Assembly

Refer to photos, diagram and parts list below

Assemble the Turntable (H) to the Main Post (D) (See Fig. 1).

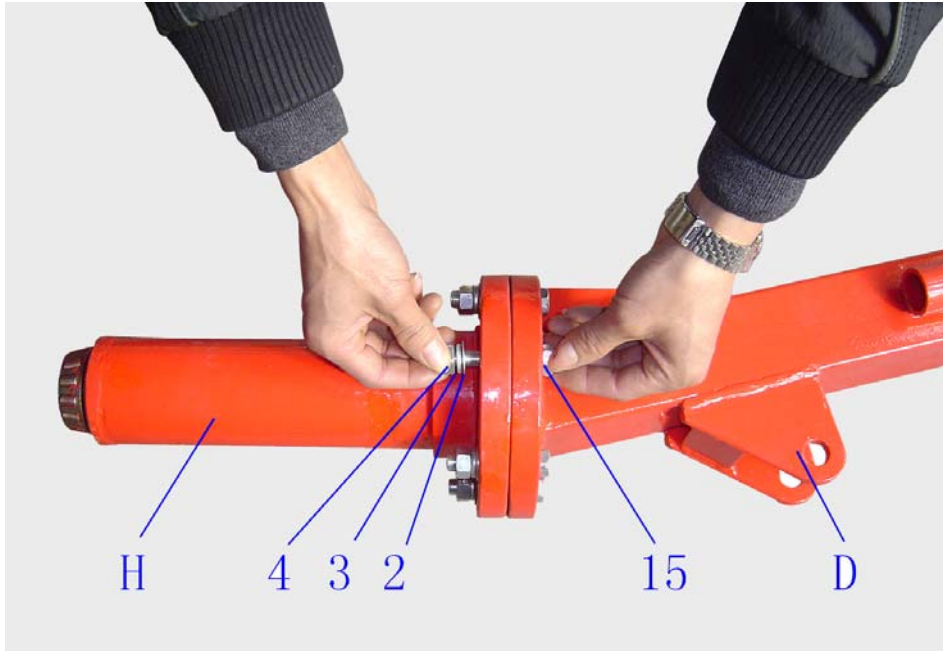

Fig. 1

Fix the Boom (C) to the Main Post (See Figs. 2 and 3).

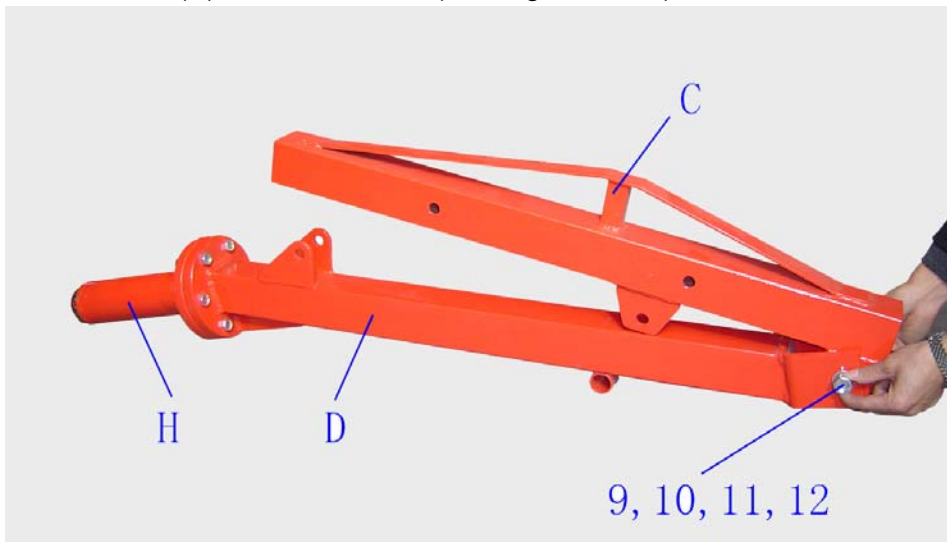

Fig. 2

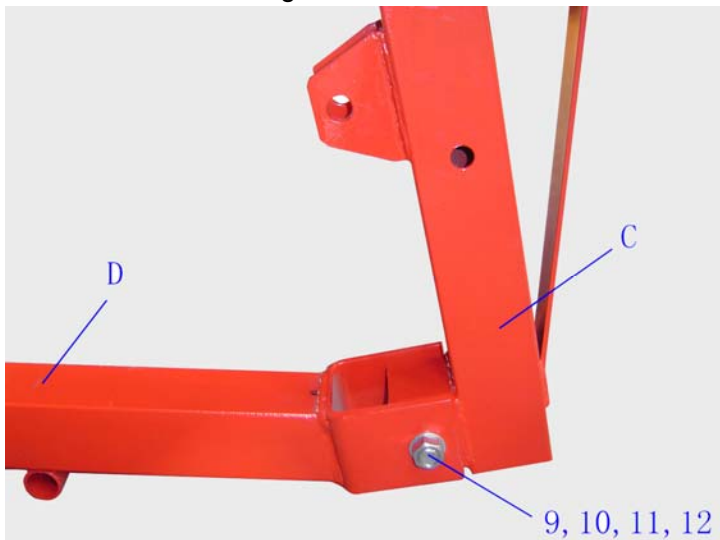

Fig. 3

Connect the Jack (F) to the Boom Main Post (See Figs. 4 and 5)

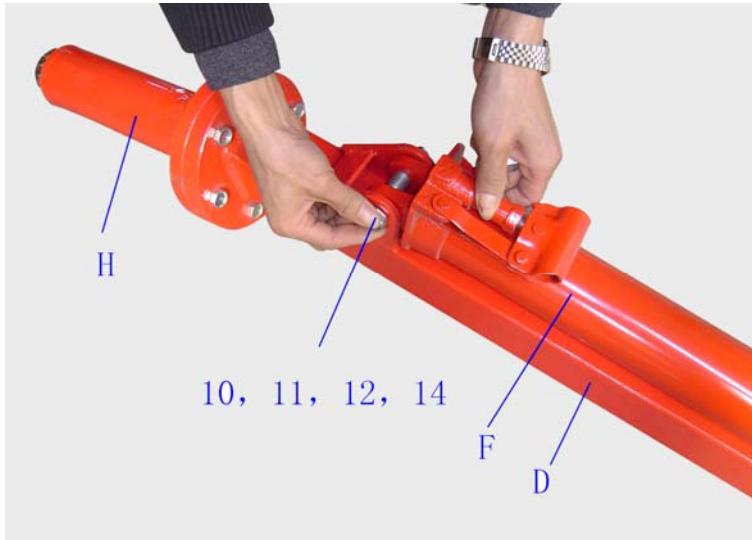

Fig. 4



Fig. 5

Secure the Base (J) to the truck bed, garage floor, or where the hoist will be used. Insert the assembled parts ( Main Post, Boom and Jack) to the Base. (See Fig 6).

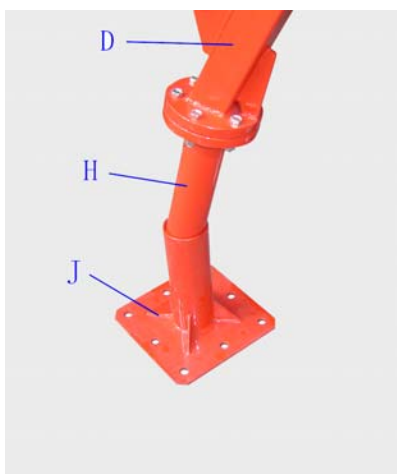

Fig. 6

Insert the Boom Extension (B) into the Boom (See Fig. 7).

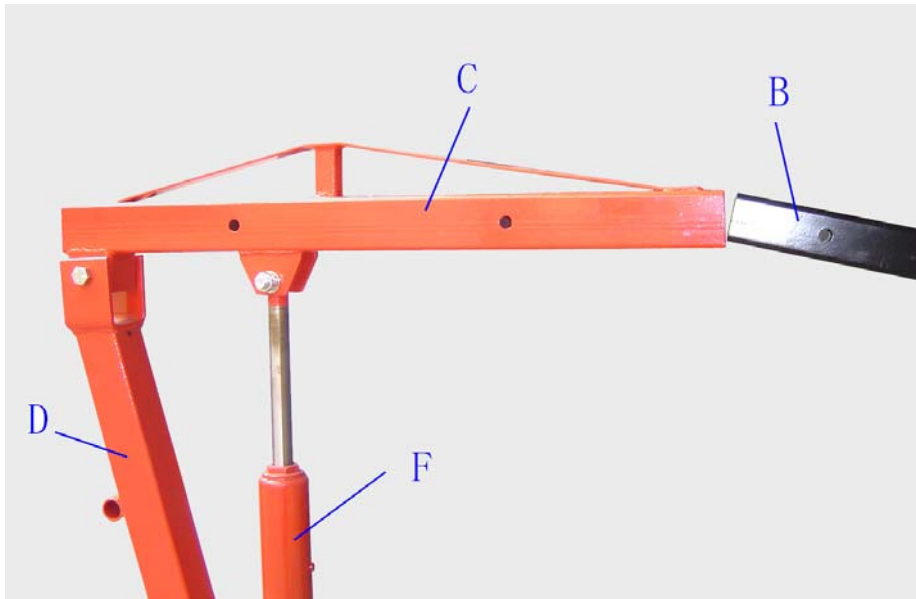

Fig. 7

Attach the Handle (E) to the Main Post, securing it with the Hitch Pin (17) (Fig. 8).

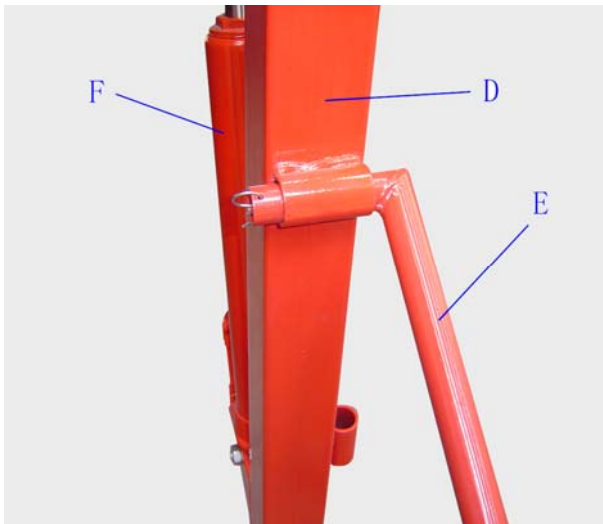

Fig. 8

Attach the Wheel Binding Bolt (18) to the Base (Fig. 9).

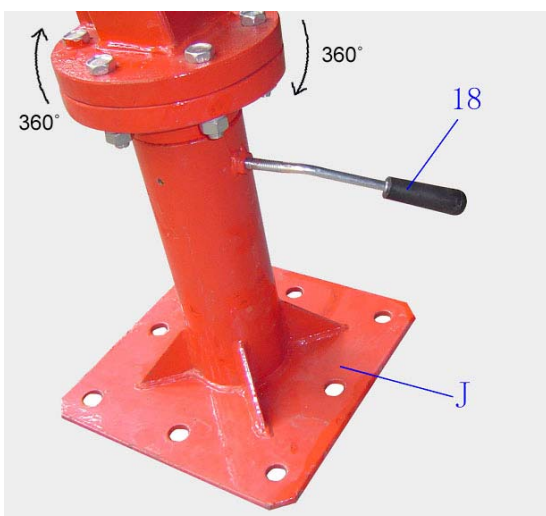

Fig. 9

## OPERATION

- To raise, turn the release valve to the right.
- To lower, turn the release valve slowly to the left.
- All the parts of pump are easily replaceable.
- To add oil, fully collapse jack and add oil to increase oil level up to oil plug. Use only hydraulic jack oil.



**CAUTION:** This product is intended for lifting purpose only, not for supporting loads. Promptly support load after jacking with appropriately rated safety stands or equivalent blocking. Do not overload this jack beyond its rated capacity marked on the side of the boom for the corresponding boom position.

# DIAGRAM & PARTS LIST

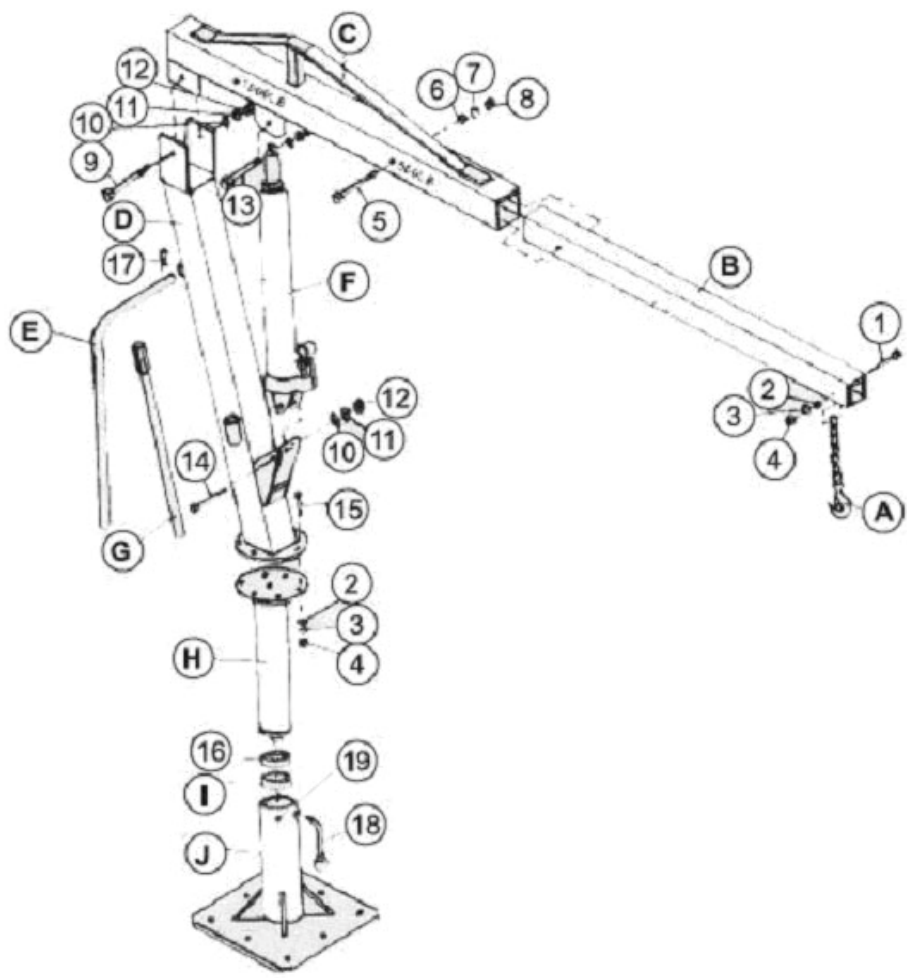

Part#	Description	Qty.	Part#	Description	Qty.
A	Chain & Hook	1	6	Flat washer $\Phi$ 14	1
B	Boom Extension	1	7	Lock washer $\Phi$ 14	1
C	Boom	1	8	Nut M 14	1
D	Main post	1	9	Bolt M 16x110	1
E	Handle	1	10	Flat washer $\Phi$ 16	3
F	Jack	1	11	Lock washer $\Phi$ 16	3
G	Jack Handle	1	12	Nut M 16	3
H	Turntable	1	13	Bolt M 16x80	1
I	Wheel hub	1	14	Bolt M 16X100	1
J	Base	1	15	Bolt M 12x40	6
1	Bolt M 12x80	1	16	Bearing	1
2	Flat washer $\Phi$ 12	7	17	Hitch Pin	1
3	Lock washer $\Phi$ 12	7	18	Wheel binding bolt	1
4	Nut M 12	7	19	Oil plug	1
5	Bolt M 14x90	1			

# EXPLODED GRAM & PARTS LIST OF OIL PUMP

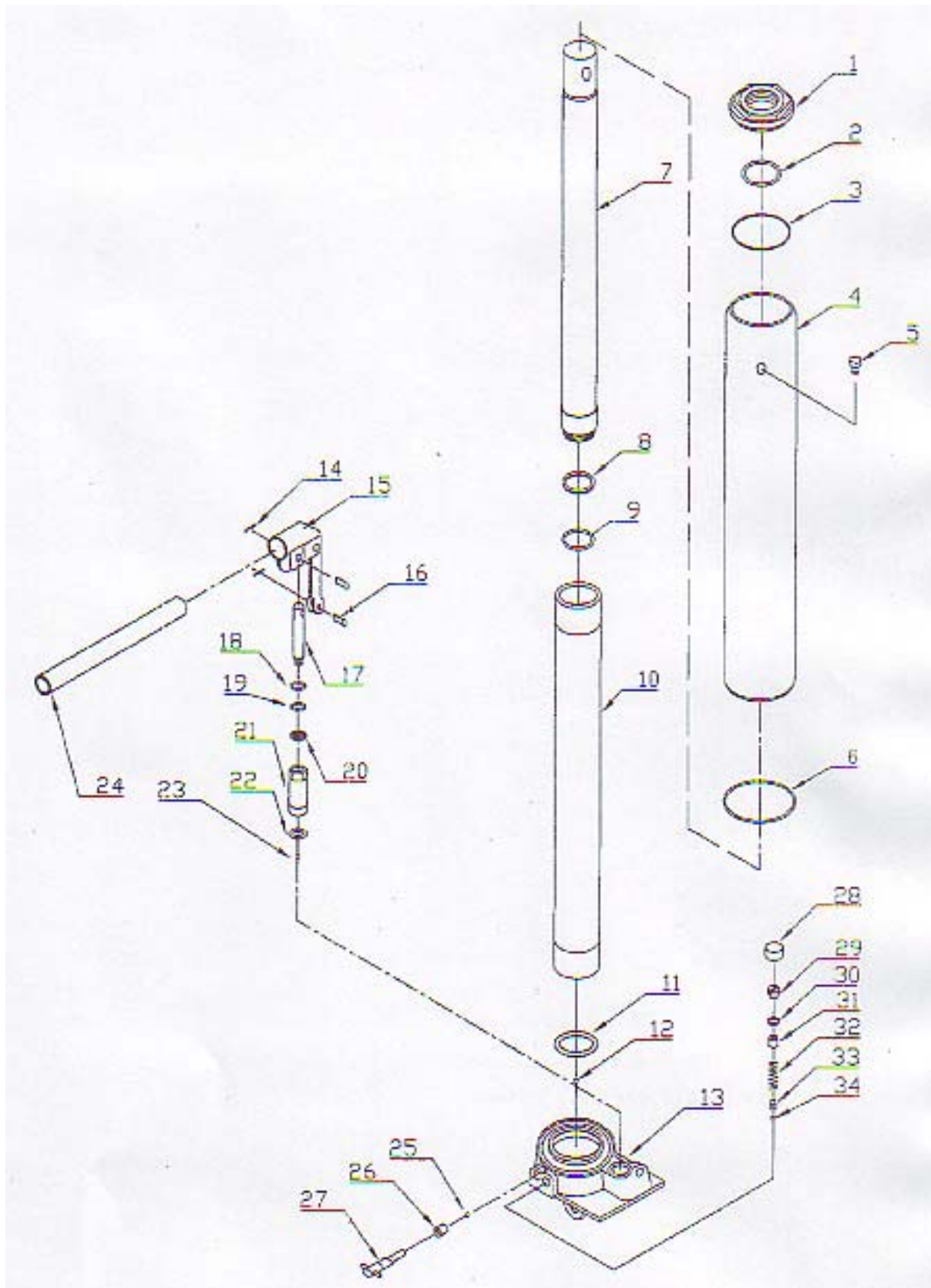

Part#	Description	Qty.	Part#	Description	Qty.
1	Top nut	1	18	Back-up Ring	1
2	O-Ring	1	19	O-Ring	1
3	Seating Gasket	1	20	J-Ring	1
4	Oil Chamber	1	21	Pump Cylinder	1
5	Oil Plug	1	22	Gasket	1
6	Seat Ring	1	23	Steel ball	1
7	Piston Rod	1	24	Handle	1
8	O-Ring	1	25	Steel ball	1
9	O-Ring Retainer	1	26	Steel Ring	1
10	Ram	1	27	Release Valve	1
11	Seat Ring	1	28	Cap	1
12	Steel ball	1	29	Release Valve	1
13	Base	1	30	Gasket	1
14	Cotter Pin	2	31	Adjusting Screw	1
15	Handle Socket	1	32	Adjusting Spring	1
16	Pin	2	33	Ball	1
17	Plunger	1	34	Steel ball	1

For replacement parts and technical questions, please call **1-800-222-5381**.

## WARRANTY

One-Year Limited Warranty



Northern Tool + Equipment Co., Inc  
 2800 Southcross Drive West  
 P.O. Box 1499 Burnsville, MN 55337-0499  
 Made in China