



40-GALLON PARTS WASHER

OWNER'S MANUAL



 **WARNING:** Read carefully and understand all **INSTRUCTIONS** before operating. Failure to follow the safety rules and other basic safety precautions may result in serious personal injury.

Item #141223

Thank you very much for choosing a NORTHERN TOOL + EQUIPMENT CO., INC. Product! For future reference, please complete the owner's record below:

Model: _____ Purchase Date: _____

Save the receipt, warranty and these instructions. It is important that you read the entire manual to become familiar with this product before you begin using it.

This machine is designed for certain applications only. Northern Tool + Equipment cannot be responsible for issues arising from modification. We strongly recommend this machine is not modified and/or used for any application other than that for which it was designed. If you have any questions relative to a particular application, DO NOT use the machine until you have first contacted Northern Tool + Equipment to determine if it can or should be performed on the product.

For technical questions please call **1-800-222-5381**.

INTENDED USE

Ideal for cleaning small mechanical parts, engine parts, etc. using effective and safe water-based detergents.

TECHNICAL SPECIFICATIONS & PACKING LIST

Item	Description
Tank capacity	40 gallons (152L)
Pump	Recirculating w/filter; 120 Volts
Product dimensions	44.48in. x 21.25in. x 35.03in. (112.98x53.98x88.98cm)

GENERAL SAFETY RULES



WARNING: Read and understand all instructions. Failure to follow all instructions listed below may result in electric shock, fire and/or serious injury.



WARNING: The warnings, cautions, and instructions discussed in this instruction manual cannot cover all possible conditions or situations that could occur. It must be understood by the operator that common sense and caution are factors which cannot be built into this product, but must be supplied by the operator.

SAVE THESE INSTRUCTIONS

WORK AREA

- **Keep work area clean**, free of clutter and well lit. Cluttered and dark work areas can cause accidents.

- **Do not use your parts washer where there is a risk of causing a fire or an explosion;** e.g. in the presence of flammable liquids, gasses, or dust.
- **Keep children and bystanders** away while operating a parts washer. Distractions can cause you to lose control, so visitors should remain at a safe distance from the work area.
- **Be aware of all power lines, electrical circuits,** water pipes and other mechanical hazards in your work area, particularly those hazards below the work surface hidden from the operator's view that may be unintentionally contacted and may cause personal harm or property damage.
- **Be alert of your surroundings.** Using parts washers in confined work areas may put you dangerously close to cutting tools and rotating parts.

ELECTRICAL SAFETY



WARNING: Always check to ensure the power supply corresponds to the voltage on the rating plate.

- **Do not abuse the cord.** Never yank tool or extension cords from the receptacle. Keep power and extension cords away from heat, oil, sharp edges or moving parts. Replace damaged cords immediately. Damaged cords may cause a fire and increase the risk of electric shock.
- **Grounded tools** must be plugged into an outlet properly installed and grounded in accordance with all codes and ordinances. Never remove the grounding prong or modify the plug in any way. Do not use any adapter plugs. Check with a qualified electrician if you are in doubt as to whether the outlet is properly grounded.
- **Double insulated tools** are equipped with a polarized plug (one blade is wider than the other). This plug will fit in a polarized outlet only one way. If the plug does not fit fully in the outlet, reverse the plug. If it still doesn't fit, contact a qualified electrician to install a polarized outlet. Do not change the plug in any way.
- **Avoid body contact** with grounded surfaces such as pipes, radiators, ranges, and refrigerators. There is an increase risk of electric shock if your body is grounded.
- **Do not let your fingers** touch the terminals of plug when installing to or removing from the outlet.
- **Ground fault circuit interrupters.** If work area is not equipped with a permanently installed Ground Fault Circuit Interrupter outlet (GFCI), use a plug-in GFCI between power tool or extension cord and power receptacle.

PERSONAL SAFETY

- **Stay alert,** watch what you are doing and use common sense when operating a parts washer. Do not use a parts washer while you are tired or under the influence of drugs, alcohol or medication. A moment of inattention while operating a parts washer may result in serious personal injury.
- **Dress properly.** Do not wear loose clothing, dangling objects, or jewelry. Keep your hair, clothing and gloves away from moving parts. Loose clothes, jewelry or long hair can be caught in moving parts. Air vents often cover moving parts and should be avoided.
- **Use safety apparel and equipment.** Use safety goggles or safety glasses with side shields which comply with current national standards, or when needed, a face shield. Use as dust mask in dusty work conditions. This applies to all persons in the work area. Also use non-skid safety shoes, hardhat, gloves, dust collection systems, and hearing protection when appropriate.

- **Avoid accidental starting.** Ensure the switch is in the off position before plugging tool into power outlet. In the event of a power failure, while a parts washer is being used, turn the switch off to prevent surprise starting when power is restored.
- **Do not overreach.** Keep proper footing and balance at all times.

TOOL USE AND CARE

- **Never use a parts washer** with a malfunctioning switch. Any parts washer that cannot be controlled with the switch is dangerous and must be repaired by an authorized service representative before using.
- **Disconnect power** from parts washer and place the switch in the locked or off position before servicing, adjusting, installing accessories or attachments, or storing. Such preventive safety measures reduce the risk of starting the parts washer accidentally.
- **Store idle parts washers.** When parts washer is not in use, store it in a dry, secure place out of the reach of children. Inspect parts washer for good working condition prior to storage and before re-use.
- **Use only accessories that are recommended** by the manufacturer for your model. Accessories that may be suitable for one parts washer may create a risk of injury when used on another parts washer.
- **Keep guards in place** and in working order.
- **Never leave parts washer** running unattended.

Operation

1. Wear suitable protective clothing, gloves and goggles.
2. Clean off any accidental splashes of degreaser on skin immediately, following the degreaser manufacturer's instructions carefully. Seek medical attention if necessary.
3. Keep work area tidy and mop up any accidental spills of degreaser.
4. Do not allow the level of liquid in the parts washer to fall below the pump inlet, as damage to the pump can result.

When not in use:

1. Switch off pump, close the lid and disconnect from the electrical supply.
2. Disconnect from the electrical supply before carrying out any maintenance or cleaning on the parts washer.

NOICE: The pump of your parts washer may be damaged if you use solvents such as methylethylketone (MEK), perchloroethylene or trichloroethylene. Use only water-base solvents with this parts washer.

ASSEMBLY

1. Remove parts washer from carton and inspect for any visual damage.
2. Remove parts inside the machine.
3. Place clean cardboard on the floor and lay machine on its lid. (Make sure you hold cover closed when laying machine on its lid.) Mount four legs on brackets with M6X12 Philips head screws and M6 nuts. NOTE: DO NOT TIGHTEN.
4. Place lower shelf between legs with flat surface up and attach to legs with M6X23 Philips head

screws and M6 nuts.

5. With legs pressed tight against lower shelf, tighten all screws to lower shelf.
6. Tighten all the screws installed in Step 4.
7. Stand machine up, being careful to hold lid closed.
8. Put work shelf and basket into the machine.
9. Mount pump assembly into slot on the side of the machine, then place filter screen in position.
10. Plug machine into standard 120 Volt 60hz grounded outlet and fill with proper amount of fluid.
11. Turn switch on. Fluid should be flowing from the flexible spigot.

When installing your parts washer:

1. Assemble it according to the instructions given below.
2. Sit it on firm, flat, level surface in a well-ventilated area and away from any open flames.
3. Fill only with a non-flammable water-based degreaser or cleaning agent to just below the level of the parts shelf (approximately 20 gallons).
4. Follow the degreaser manufacturer' s instructions carefully.
5. Do not fill with flammable solvents such as kerosene, gasoline, etc.
- 12.

MAINTENANCE



WARNING: Make sure the parts washer is disconnected from its power source before attempting any maintenance, cleaning, or inspection.

- **Maintain your parts washer.** It is recommended that the general condition of the parts washer be examined before it is used. Keep it in good repair by adopting a program of conscientious repair and maintenance in accordance with the recommended procedures found in this manual. If any abnormal vibrations or noise occurs, turn off immediately and have the problem corrected before further use. Have necessary repairs made by qualified service personnel.
- **Cleaning.** Use only soap and a damp cloth to clean your parts washer. Many household cleaners are harmful to plastics and other insulation. Never let liquid get inside the electric pump.
- The lid stay incorporates a fusible link to close the lid in the event of a fire. This link is non-resetting and must be replaced in the event of its operating.
- Clean the pump filter regularly by sliding it away from the pump housing and rinsing in clean degreaser.

DIAGRAM & PARTS LIST

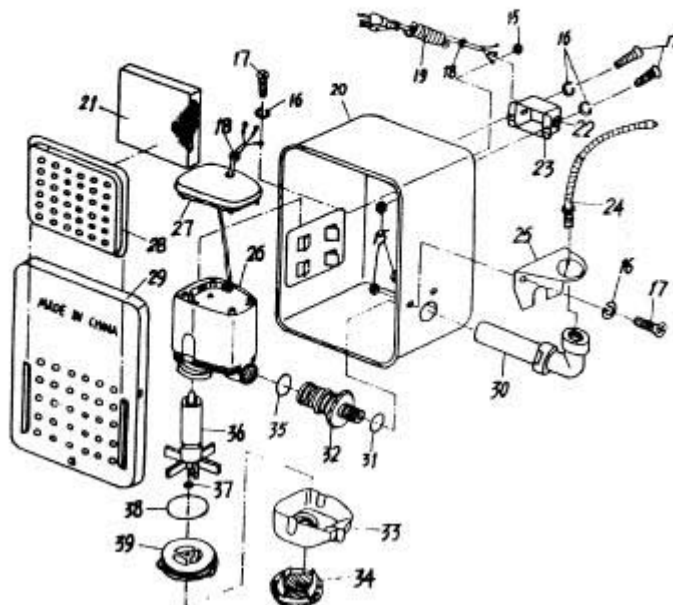
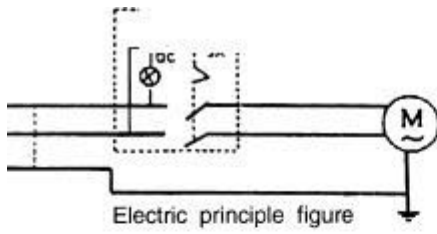
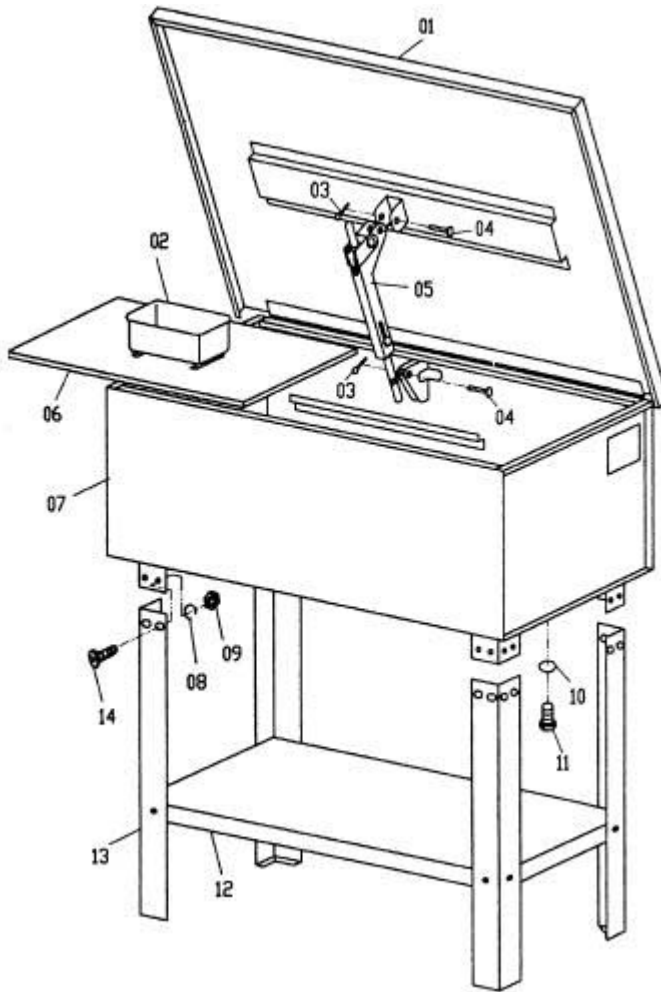

Part#	Description	Qty.	Part#	Description	Qty.
01	Cover	1	21	Screen	1
02	Work basket	1	22	Switch	1
03	Spring pin	2	23	Switch box	1
04	Pin	2	24	Flexible pipe	1
05	Safety plate	1	25	Elbow seat	1
06	Work shelf	1	26	Pump body	1
07	Body	1	27	Pump back cover	1
08	Spring washer	24	28	Filter cover	1
09	Nut	24	29	Pump housing cover	
10	O-ring	1	30	Elbow	1
11	Plug	1	31	Plastic washer	1
12	Shelf	1	32	Spigot	1
13	Leg	4	33	Location of knob	1
14	Pan screw	24	34	Filter	1
15	Nut	5	35	Seal ring	1
16	Spring washer	5	36	Impeller	1
17	Screw	5	37	Shin washer	2
18	Stain relief	2	38	Seal ring	1
19	Cable & plug	1	39	Impeller holder	1
20	Pump housing	1			

For replacement parts and technical questions, please call **1-800-222-5381**.

WARRANTY

One-Year Limited Warranty



Northern Tool + Equipment Co., Inc.
2800 Southcross Drive West
P.O. Box 1499 Burnsville, MN 55337-0499
Made in China